

Reversible & standard Fans

Reversible fans can be used to free the radiator of debris, keeping the engine cooler and running more efficiently. As a result, this prolongs the life of the engine.

How Reversible MGT Fans work

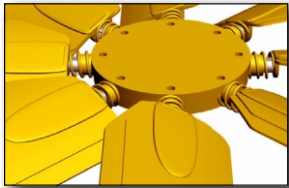

1. With the engine off, the ignition locked in the off position, and any required guarding removed, you are now ready to reverse your fan. There is a pink "DANGER" tag provided with your fan that should also be fastened to the ignition switch panel.

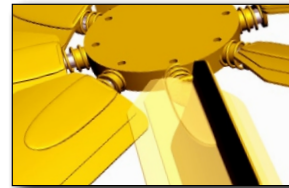

2. Individually reverse each blade by simply pushing inward (towards the hub) to compress the spring and then begin to rotate the blade; it should only turn in one direction.

3. Once the blade begins to rotate, you no longer need to keep pushing inward; continue to turn the blade toward the desired position.



4. Once the blade is rotated fully to the desired position, the blade will "spring" outward and lock itself into place. Now the blade will not be able to be turned around without pushing it inward again.

The reversing of one blade is now complete; continue to reverse the remaining blades so that they are all in the same position.

5. Now that all of the blades have been reversed, the fan will force the air in the opposite direction. You are now ready to re-install the guarding, unlock the ignition switch, and continue operating the equipment with increased comfort.

Reversible Fans

Part No.	Machine Model
1251362	D6R, D6T, D7H & D7HLGP, D8N
1359960	D9R
1479670	D7G
1479672	D8K, 583K, 983B/D

* Other part no. not included in the list are available. Please contact your sales representative if you have any questions. Part Numbers are used for reference purposes only.

Standard Fans

Part No.	Machine Model
1080725	D6M
1188458	D7R, D8R
1197864	938G, IT38G, 950G, 120H, 135H, IT62G, 962G
1200300	M318, M320
1265975	416C, 416D
1423391	416C
1730419	D8R
1786578	320C/C L/C LN, 318C L/C LN, 319C LN, 320C U/C LU
1947049	12H, 120H, 14H, 140H, 140H NA, 135H, 160H, 163H
2040910	320C, 320CL, 320CLN, 330C, 330CL, 330CLN
2302892	320E
2459343	320D, 320D L, 321D LCR
2459344	320D/D2, 320D L, 320D LN, 323D, 323D L, 321D
2501911	583T, 587T, D8R, D8T
1N8173	3304/B, 3306, 3512, G3408, G333C, D333C
1P7936	235B, 235C, 235D, 627B
1S0572	D8H, D8
1W7940	D6H, D6HLGP, D6H-XL, D6H-LS, D6H-XR
2P2521	CS-573/C, CS-533/C, CS-531, CS-583/C, CP-533, CP-563C
2P8907	12G, 120G, 14G, 130G, 160G
2S4638	633C, 637, 988, D8H
2W5082	D8L
3N2444	255
4I7592	320, 320L, 320N
4N2572	330
4N3092	C9, 350, 350L
4N3339	3406, 3408B/C/E, 3412/C/E, 3508, C15, C18, C27, C32, 3516, D379/B
4N8344	955, G936, 936E, D5B
4N8434	16H, 16G, 621B
4N8871	D4D, D4H, D4H-XL, D4H-LPG, 517, IT18B, IT28B, 916, 926E/F, D4E, G926
4W0255	973, 966D, D6R, D7H
4W8409	D8K
5I7894	317, 318BL & BLN
5I8000	320, 320L, 320N, 315C, 315CL
5M5880	D5, 950, 951, 955
5M5881	12E
5S1421	966C, D7E
5S9897	D4D, 561, 574
6I1363	910, 931

* Other part no. not included in the list are available. Please contact your sales representative if you have any questions.
Part Numbers are used for reference purposes only.

Standard Fans - Cont'

Part No.	Machine Model
6I1364	IT12, 931C, 935B/C, D3C, D3C-LGP, 931B, 910, D3, D4B, D4C, D4C-LGP, G910, D3B
6N2687	C15, C16, C18, R1600/G/H, R1700, R2900, 980C/F, TH35-C151, 826C, 983B
6N5339	534B, 836, 988B
7C5591	3304
7E3557	R1700G, 815F, D7R, 966F, 572R, 814F, 970F, R2900, 966
7N0476	963, 950B
7N2131	D8L
7N8253	924F, 924F, D5H, IT24F
7S0542	920, 930, 350, D4, D5
7S0543	D5
7S0544	D6C, 613C, D5B, 955L
7S0545	627, 875, 966
7S0546	966, 966C, 966R, 977L,
8N0036	235B, 235C, 235D, 627B
8N6584	D6D
9M1904	950
9N6010	322C, 325
9S9696	D7, D7F, D7G, 572G
9Y7840	950F

Guards

Part No.	Machine Model
1P7763	D6C, D6D, D6F
1P7764	D6C, D6D, D6G